



Micropac® MPP- Panel Pumps

A rugged, bulkhead mountable hand pump, available as two-speed or single-speed, up to 300 bar.

RUGGED BASE PLATE FIT BEHIND YOUR PANEL/ RESERVOIR/BULKHEAD

SEALED HANDLE SHAFT DETACHABLE HANDLE FITTED

HOLD/RELEASE VALVE KNURLED KNOB FITTED

T, P & P (AUX) CONNECTIONS FOR EASY INSTALLATION. ADJUSTABLE RELIEF VALVE.

MPP Pump mounted behind your panel/bulkhead/reservoir. Our handle & release knob are compact, ergonomic & 316 stainless for harsh environments. Add your gauge and auxiliaries.

OPERATING SIDE

Low corrosion MPP Pump mounted behind your panel/bulkhead/reservoir. Adjustable relief valve, tank port, P and gauge ports. Connect your auxiliaries like gauge, sector valve or 4 way directional valve. Total flexibility for a low cost, rugged and low corrosion hydraulic panel for yacht or rig.

REVERSE SIDE

Serviceable
for sustainability

MADE IN BRITAIN

TYPICAL APPLICATIONS:
YACHT HYDRAULIC CONTROL SYSTEMS
OFFSHORE CUSTOMER MANUAL POWER
HYDRAULICS FOR HARSH ENVIRONMENTS

FEATURES

- Rugged & proven pump module base for your custom yacht or offshore hydraulic panel
- Highly cost effective.
- Effective configuration. Handle & release valve face the marine environment. Pump & connections sealed behind your panel.
- Add auxiliaries like gauge, selector or 4 way valves to meet your exact marine hydraulic panel requirement.
- Horizontal or vertical mounting
- G3/8 Tank port. G1/4 Pressure & auxiliary ports
- Ergonomically designed for ease of operation
- Rugged rotary actuated handle, pumps on both strokes
- 316 stainless facing the weather
- Mineral oil duty
- Single speed and two speed models
- Long life hard chromed 316 stainless piston rod
- Dirt excluder and PTFE low friction sealing
- Soft-seat check valve for positive sealing
- User serviceable sealing & seating components
- Detachable 300, 450mm or 625mm operating handle
- Nitrile seals standard - optional EPDM/ Viton®
- Quality British design & manufacture
- Factory support for product and application

INSTALLATION & MAINTENANCE

APPLICATION

The Micropac MPP series units allow you to configure your own customer hydraulic panel around this cost effective and rugged module. The handle and release valve are the only parts facing the weather and are 100% 316 stainless. The pump module is the other side of your panel, bulkhead or reservoir and sealed from the weather.

Add auxiliaries like a gauge, selector valve or four way valve for double acting cylinders to customise your panel to your requirements. Pipe up behind the bulkhead. Our unit is sealed front to back.

The unit uses our proven Micropac parts which can be found in hand pumps across the globe. For use on mineral oil.

The handle orientation can be moved 90 degree's left, right or upside down on the model indicated below, which gives options for installation position to have the handle pointing in the most convenient operating position.

The dual speed model comes with an automatic changeover valve which gives you maximum flow up to around 100bar, before automatically switching over to high pressure operation which will allow you to pump to the max pressure of 300bar.

Although this type of module is widely used for yacht hydraulics where you need to control multiple single acting cylinders in an extreme marine environment, the MPP has application for defence and other offshore systems.

MATERIALS

The unit uses 316/1.4404 stainless steel on the parts exposed to the environment outside the panel. The materials behind the panel are low corrosion, these being 316 stainless, bronze CW307g and hard anodised alloy 6082T6 external materials.

CONNECTIONS

The unit has an inlet port of 3/8BSP for you to connect your tank feed to and 1/4BSP pressure outlet ports for your main outlet plus a pressure gauge. Ensure that the tank connection is of adequate bore. Maximum head 1 metre.

MAINTENANCE

Maintenance operations should only be carried out by a competent service engineer.

The inlet strainer is inside the reservoir and as the system is sealed, should only need cleaning during service. Service kits are available.

Sarum Hydraulics Ltd also offer a servicing facility. Please advise before returning the unit to us. Quote serial numbers.

SAFETY

Any pump is a component forming part of a hydraulic pressure system. The system should be designed, operated and maintained in accordance with statutory requirements and other relevant instructions.

DIMENSIONS

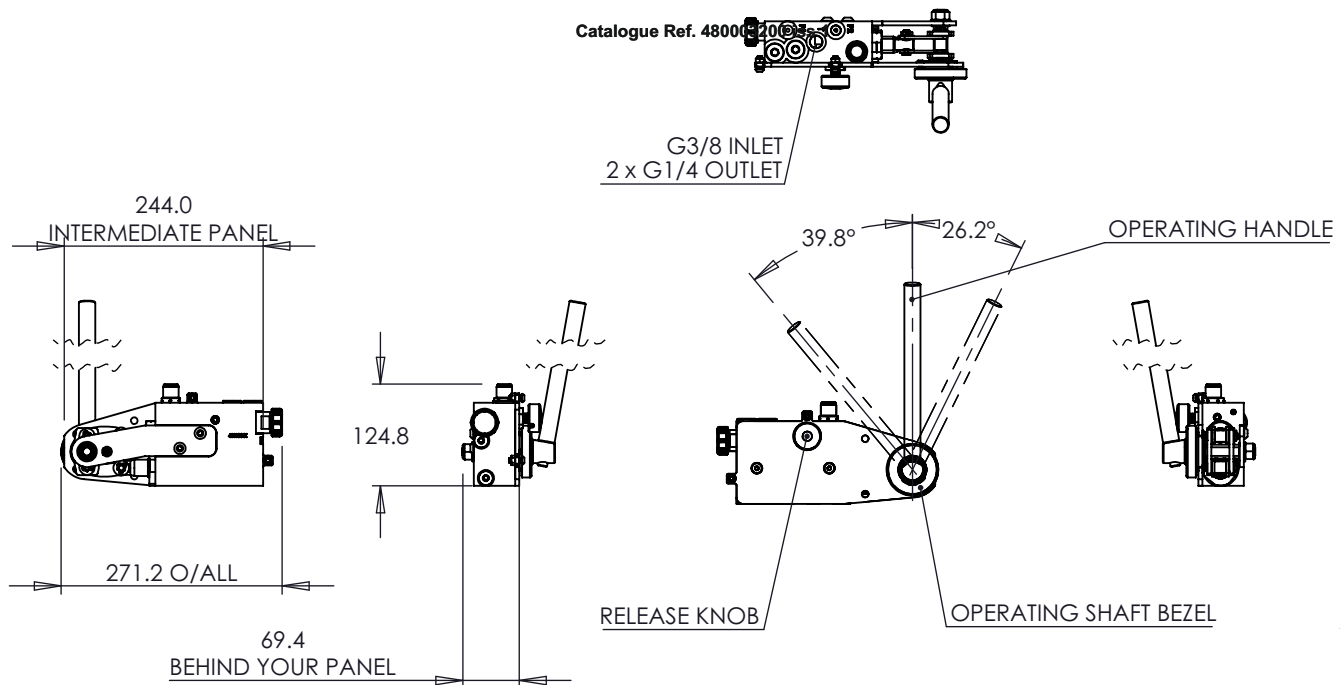

We are a long established ISO 9001 designer and manufacturer of hydraulic equipment. Full details of other products in our range are available from:

Sarum Hydraulics Limited
Unit 1 Danebury Court, Salisbury SP4 6EB, UK
Tel: 44(0)1722 328388 Fax: 44(0)1722 414307
email: pumpsales@sarum-hydraulics.co.uk
www.sarum-hydraulics.co.uk

We invest heavily and continuously in product development. Specifications are therefore liable to change without prior notification.

©Micropac is a Registered Trade Mark of Sarum Hydraulics



SARUM
HYDRAULICS
Designers & Manufacturers of Micropac® Hydraulics



ORDERING CODE BUILDER FOR MICROPAC® MPP SERIES PUMP

Model	
Pump Body Material	
A	Anodised Aluminium & Bronze, weather facing is 316 stainless as standard
Displacement / Single Speed or Two-Speed	
S	Single speed - 5.8cc / Double stroke up to 300 bar
D	*Dual speed - 17.4cc / Double stroke LP to 100 bar 5.8cc / Double stroke HP up to 300 bar
Handle	
3	300mm
4	450mm
6	625mm
O	No Handle
Seal Material	
N	Nitrile
V	Viton Fluorocarbon
E	EPDM
Test fluid	
O	Oil
S	Special (consult factory)
Release Valve	
O	No Release
R	Normal
S	Special
Relief Valve	
O	No Relief
R	Normal
S	Special

*The dual speed unit comes with an automatic changeover valve which swaps over at 100 bar to high pressure operation.

For special options, please consult factory. Relief valve is set to the maximum working pressure of the pump as standard, unless otherwise specified.

M P P A

Sarum Hydraulics Limited
Unit 1 Danebury Court, Salisbury SP4 6EB, UK
Tel: 44(0)1722 328388 Fax: 44(0)1722 414307
email: pumpsales@sarum-hydraulics.co.uk
www.sarum-hydraulics.co.uk

We invest heavily and continuously in product development. Specifications are therefore liable to change without prior notification.
®Micropac is a Registered Trade Mark of Sarum Hydraulics. E&OE.

