



Micropac® MGS- Subsea

An very low corrosion 316 hand pump specifically suitable for subsea use including Diving Bells

G1/2 BOSS
PLUGGED FOR
EQUALISER/ADDITIONAL
CONNECTIONS/FILLING
4 PLACES

MICROPAC SINGLE SPEED
DOUBLE ACTING HAND PUMP
MW-6 SERIES. 4 MODELS
50CC/100 BAR TO 7CC/700 BAR.
RELEASE/RELIEF VALVE OPTIONS
OPTIONAL 4 WAY DIRECTIONAL
VALVE

Serviceable
for sustainability

VERTICAL ORIENTATION

HORIZONTAL ORIENTATION

316 /1.4404 RESERVOIR
4 LITRE HORIZONTAL/
2.5 LITRE VERTICAL

TYPICAL APPLICATIONS:
DIVING BELL DOOR PUMP
SUBSEA MANUAL HYDRAULIC POWER
STANDBY HYDRAULICS IN HOSTILE ENVIRONMENTS
SUBSEA USING AN EQUALISER.
RESERVOIR IS NOT A PRESSURE VESSEL

FEATURES

- Horizontal or vertical mounting
- Integral reservoir 4L horizontal/ 2.5L vertical mount
- Multi fluid including water oil & glycols
- Ergonomically designed for ease of operation
- Double acting operation- pumps on up & down strokes
- 316 stainless and bronze construction
- Four models cover max. pressures 50 - 700 bar
- Four bosses for auxiliaries like equaliser
- Sturdy construction- suitable for extreme environments
- 4 way directional valve option for double acting actuators
- Long life hard chromed stainless piston rod
- Dirt excluder and PTFE low friction sealing
- Standard unit for single acting actuators
- Soft-seat check valve for positive sealing
- Pressure gauge, release & relief valve options
- User serviceable sealing & seating components
- Detachable 450mm or 625mm operating handle
- Nitrile seals standard - optional EPDM/ Viton®
- Reliable- quality British design & manufacture
- Factory support for product and application

INSTALLATION & MAINTENANCE

APPLICATION

The Micropac MGS series units are designed to offer extended service life where industry standard alloy and carbon steel units are not viable in offshore or, subsea applications. The unit is fitted with a Micropac MW hand pump on a 316 stainless reservoir.

The reservoir is not a pressure vessel. We offer additional bosses for connection of an equaliser or bladder to balance the pressure.

MW hand pumps are compatible with a wide range of fluids. See the MW datasheet or contact the factory for details.

MATERIALS

The unit uses 316/1.4404 stainless steel and bronze cw307g external materials. Wetted parts are stainless 316, bronze cw307g and small amounts of stainless 302/ 303/ 304/ 420/ 431.

CONNECTIONS

The Micropac MW hand pump as fitted to the unit has a standard male/male adaptor to 1/4bsp male coned. Optional hexagon adaptors to female NPT are available.

There are four identical G1/2 bosses.. A Stainless steel filler breather is available. A second plugged G1/2 port is provided for a return or equaliser connection, simplifying connection. Two spare bosses are plugged and offer flexibility on piping of the unit. Blank the release cavity and specify an external ball valve for lever release operation for gloved hands.

SAFETY

Any pump is a component forming part of a hydraulic pressure system. The system should be designed, operated and maintained in accordance with statutory requirements and other relevant instructions.

DIMENSIONS

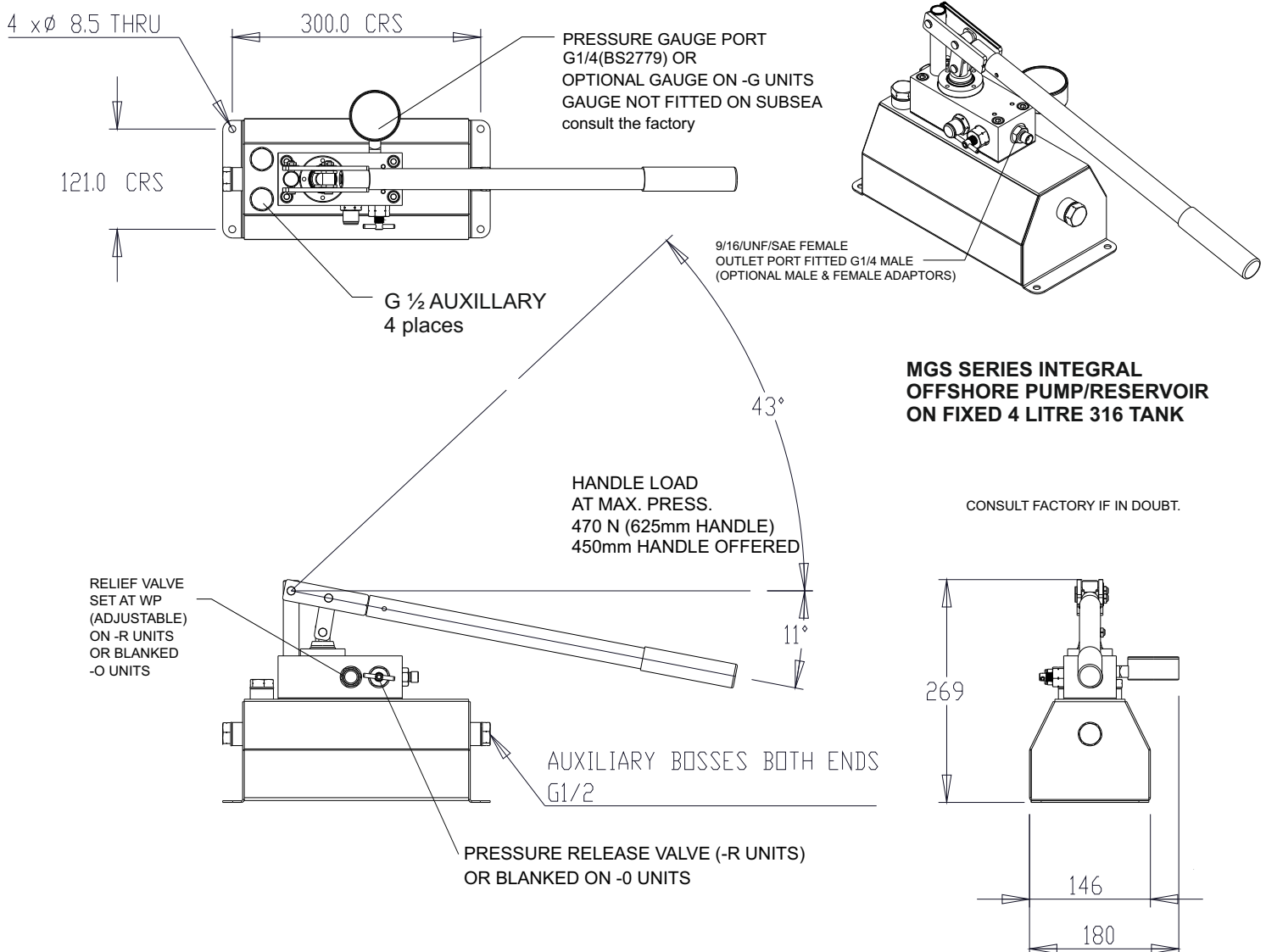

We are a long established ISO 9001 designer and manufacturer of hydraulic equipment. Full details of other products in our range are available from:

Sarum Hydraulics Limited
Unit 1 Danebury Court, Salisbury SP4 6EB, UK
Tel: 44(0)1722 328388 Fax: 44(0)1722 414307
email: pumpsales@sarum-hydraulics.co.uk
www.sarum-hydraulics.co.uk

We invest heavily and continuously in product development. Specifications are therefore liable to change without prior notification.

©Micropac is a Registered Trade Mark of Sarum Hydraulics



SARUM
HYDRAULICS
Designers & Manufacturers of Micropac® Hydraulics
Catalogue Ref. 403002700 iss 2
Page 2 of 3



ORDERING CODE BUILDER FOR MICROPAC® MGS SERIES PUMP

Model			
Body Material			
6	Stainless 316 / Bronze		
Displacement			
07	7cc / 700 BAR	25	25cc / 207 BAR
12	12cc / 407 BAR	50	50cc / 102 BAR
Handle			
4	450mm Short		
6	625mm Long		
O	No Handle		
Seal Material			
N	Nitrile		
V	Viton	S	Special
Test fluid			
W	Water		
O	Oil	S	Special
Release Valve			
O	No Release		
R	Normal		
S	Special		
Pressure Gauge			
O	No Gauge- std spec.		
G	Gauge fitted		
S	Special		
Relief Valve			
O	No Relief		
R	Relief valve fitted		
S	Special		
Tank Size			
4S	4* Litre Subsea Fixed 316		

* Only a 2.5 Litre capacity when used in vertical orientation

M G S 6 [] [] [] [] [] [] [] [] 4 S

Sarum Hydraulics Limited
Unit 1 Danebury Court, Salisbury SP4 6EB, UK
Tel: 44(0)1722 328388 Fax: 44(0)1722 414307
email:pumpsales@sarum-hydraulics.co.uk
www.sarum-hydraulics.co.uk

For special options, please consult factory.
Gauge, release valve and relief valve are set to the maximum working pressure of the pump as standard. Consult factory on special subsea gauges.