

MW-3-07 CUSTOMER EXPLODED DRAWING

7cc/double stroke to 700 bar, stainless steel construction

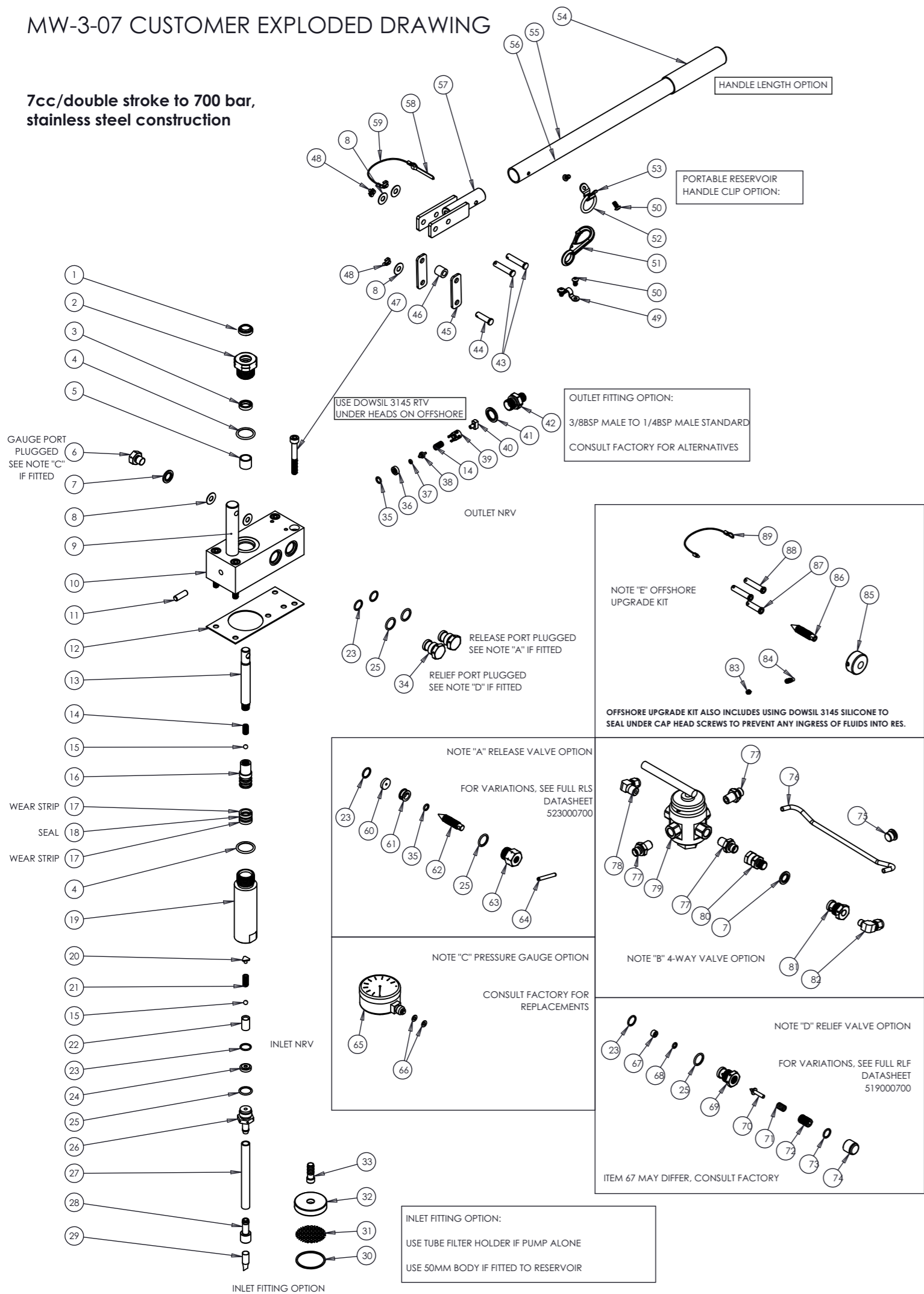

ITEM NO.	PART NUMBER	Description	QTY.
1	901201300	14mm WIPER	1
2	007039200	PISTON BEARING 14mm	1
3	901212700	T SEAL	1
4	901307600	ORING	2
5	007005500	SPACER	1
6	908001200	PLUG	1
7	901600600	BONDED WASHER STAINLESS, NITRILE	2
8	904100200	NYLON WASHER	5
9	007031300	HANDLE PILLAR	1
10	007039000	700BAR BODY - 316	1
11	907006500	DOWEL	1
12	007018500	GASKET	1
13	007007200	12cc PISTON ROD	1
14	007007100	COMPRESSION SPRING	2
15	902000500	BALL (S/S)	2
16	007004600	PISTON 12cc BRONZE	1
17	901200600	12cc PISTON SLYDRING	2
18	901207000	19mm GLYDRING + ORING	1
19	007039100	700BAR BARREL - 316	1
20	007012800	STOP	1
21	007012700	COMPRESSION SPRING	1
22	007034600	INLET SPACER	1
23	901308000	ORING	5
24	044001000	HP INLET NRV SEAT	1
25	901301700	ORING	5
26	007039500	INLET HOSE CONNECTOR - 700BAR	1
27	913001800	DIPTUBE, CUT 300mm	1
28	442006200	HOSE TAIL TO FILTER ACETAL	1
29	088002600	FILTER	1
30	901507000	PTFE BACKUP RING SOLID	1
31	442003400	FILTER ELEMENT	1
32	442003100	FILTER BODY DELRIN	1
33	442003000	INLET TAIL TUBE	1
34	007014600	RV BLANKING PLUG 316	2
35	901300300	ORING	2
36	007019000	OUTLET NRV SEAT	1
37	901300800	ORING	1
38	007019500	POPPET	1
39	007010300	NON-RETURN VALVE SPACER	1
40	242008000	RETAINER	1
41	901602700	BONDED WASHER STAINLESS	1
42	908108500	M/M ADAPTOR 10K	1
43	007011300	MEDIUM PIN	2
44	007011400	SHORT PIN	1
45	007012000	LINK	2
46	904300100	SPACER	1
47	904000900	SOCKET CAP HD. A4	4
48	907000100	COTTER PIN	3
49	911200400	SMALL DECK EYE	1
50	904000500	SOCKET BUTTON CAP A4	4
51	911200100	HANDLE CLIP	1
52	911200300	HANDLE RING	1
53	911200500	HANDLE SPAR CLIP	1
54	909001500	GRIP	1
55	007017800	450mm HANDLE, 316 SS	1
56	007018000	625mm HANDLE, 316 SS	1
57	007039400	700BAR CLEVIS - 316	1
58	907000700	COTTER PIN	1
59	007063700	LANYARD W/ COPPER FERRULES	1
60	007015000	RELEASE SEAT - PEEK	1
61	007015500	SPACER	1
62	007015200	RELEASE SCREW - 303	1
63	007015400	RELEASE BODY 316	1
64	907000400	SELOC PIN A2	1
65	SEE OPTIONS	PRESSURE GAUGE	1
66	904102300	COPPER WASHER	2
67	118010800	1MM SEAT - PEEK	1
68	901306500	ORING	1
69	118003200	RELIEF BODY - 316	1
70	007016300	PLUNGER	1
71	519000500	RELIEF SPRING	1
72	007016200	RELIEF SCREW	1
73	901300700	ORING	1
74	007016800	DUST CAP	1
75	908002400	OUTLET PLUG	1
76	007066800	RETURN TUBE 316	1
77	908107500	M/M ADAPTOR	3
78	908115500	COMPRESSION ELBOW FITTING	1
79	916100500	4-WAY VALVE	1
80	908158100	MALE TO FEMALE SWIVEL 316	1
81	007050600	RETURN PLUG	1
82	908115700	TUBE COMPRESSION ELBOW	1
83	904020700	GRUB SCREW A4	1
84	904024100	GRUB DOG POINT A4	1
85	439006300	KNOB 316	1
86	007045800	RELEASE SCREW - 316	1
87	007054000	SHORT PIN - 316	1
88	007045900	MEDIUM PIN - 316	2
89	007063800	LANYARD W/ STAINLESS FERRULES	1

This unit is a standard Micropac Stainless Steel Hand Pump. Ordering options are in our data sheet. Also available as 12cc/407 bar, 25cc/204 bar, 49cc/102 bar & 100cc/50 bar. Please consult Sarum Hydraulics for more information on our range of pumps to meet a wide range of operating requirements.

For Service Kits and Spare Parts, please consult the factory. We can offer comprehensive seal kits, with instructions and a video tutorial, which can be found here:



Alternatively, you can return the complete hand pump to our Salisbury Factory for us to investigate and repair for you. Please contact us before returning the pump.

Use and maintenance to be in accordance with written instructions.

Unit for use on approved fluids only. Consult factory if in doubt.

While every effort has been made to ensure the accuracy of this exploded drawing and bill-of-materials, this document is for reference only and may be updated or modified without prior warning at any time.

No unauthorised reproduction in whole or part without the written permission of the Copyright holder.

Micropac is a Registered Trade Mark of Sarum Hydraulics

This drawing is suitable for any variation of an MW-3-07 (7cc) hand pump. The basic hand pump has blanking plugs fitted, and accessories are shown in the "Note" boxes.

Sarum Hydraulics Ltd.
Unit 1, Danebury Court
Old Sarum Park,
Old Sarum,
Salisbury, Wiltshire
United Kingdom
website: www.sarum-hydraulics.co.uk
email: pumpsales@sarum-hydraulics.co.uk

