

DUO Combined Air Driven / Manual Hydraulic Hand Pump Units Index for drawings

What do we offer?

Our Micropac® DUO is a combination unit which utilises an air-driven pump, and one of our hydraulic hand pumps which gives you the flexibility to move lots of fluid with no effort, and then fine tune by hand up to your desired test pressure.

Air driven pumps are available with flow rates up to 8L/min ("Hi-Flo" units), or maximum pressures up to 700 bar ("Compact" units.)

Hydraulic hand pumps can be **single-speed** or **two-speed**. Options from 50 bar to 700 bar max pressure.

These pumps are then fitted to our 316 stainless steel two-wheel trolleys, with capacity of **20L** or **50L**.

See Datasheet 250002900 for ordering codes.



Page	Drawing Number	Description
2	DUO-C-MW-2T	DUO unit, with a "Compact" air driven pump, coupled with a Single Speed "MW" hand pump, fitted on a 20 litre two-wheel trolley.
3	DUO-C-MW-5T	DUO unit, with a "Compact" air driven pump, coupled with a Single Speed "MW" hand pump, fitted on a 50 litre two-wheel trolley.
4	DUO-H-MW-5T	DUO unit, with a "Hi-Flo" air driven pump, coupled with a Single Speed "MW" hand pump, fitted on a 50 litre two-wheel trolley.
5	DUO-C-MD-2T	DUO unit, with a "Compact" air driven pump, coupled with a Two Speed "MD" hand pump, fitted on a 20 litre two-wheel trolley.
6	DUO-C-MD-5T	DUO unit, with a "Compact" air driven pump, coupled with a Two Speed "MD" hand pump, fitted on a 50 litre two-wheel trolley.
7	DUO-H-MD-5T	DUO unit, with a "Hi-Flo" air driven pump, coupled with a Two Speed "MD" hand pump, fitted on a 50 litre two-wheel trolley.

IF IN DOUBT, ASK THIRD ANGLE PROJECTION

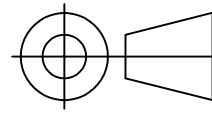

TOLERANCES UNLESS OTHERWISE STATED
 GENERAL TOLERANCES RIGHT ANGLE BENDS &
 NO DEC. PLACE +/-1.0mm OTHER ANGLES +/-1°
 ONE DEC. PLACE +/-0.3mm MACHINED DIAMETERS
 TWO DEC. PLACE +/-0.1mm CONCENTRIC WITHIN
 +/-0.1mm T.I.R.
 SCREW THREADS ARE ISO METRIC COARSE PITCH
 TOL. 6g/6H (MED. FIT) TO BS3643
 WIRE DIA./PLATE THICKNESS TO COMMERCIAL LIMITS
 GEOMETRICAL TOLERANCING TO BS308 PART 3

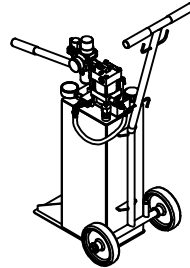
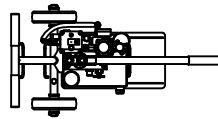
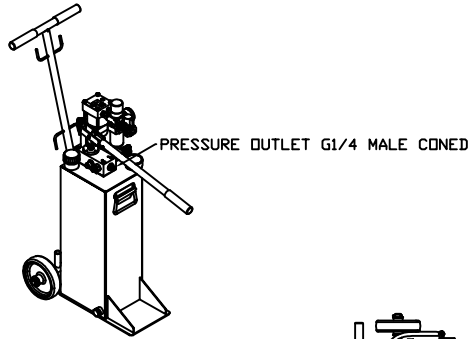

HYDRAULIC CIRCUIT
STANDARD TEST/FILLERUNIT
NOTE OPTIONS FITTED

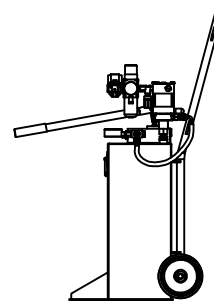
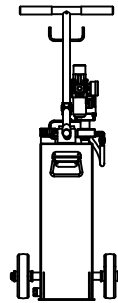
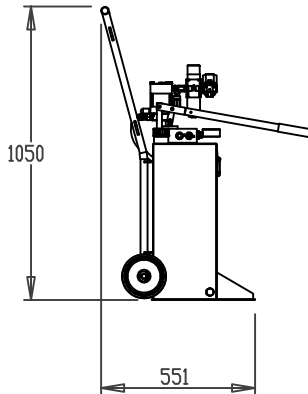
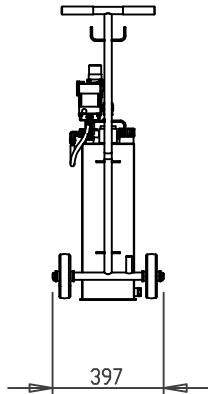
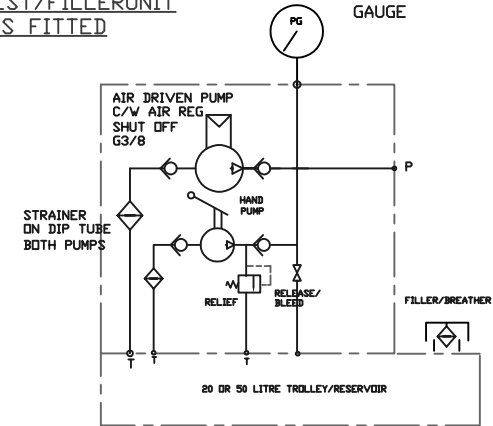

NOTES:

- UNIT MANUFACTURED FROM STANDARD SARUM HYDRAULICS MICROPAC PUMP COMPONENTS
- AIR DRIVEN PUMP SECTION: 'COMPACT' MODEL SHOWN
 SEE DATASHEET FOR MODELS
 'COMPACT' UNITS UP TO 3.6 LITRES/MINUTE
 OR UP TO 740 BAR
 MATERIALS OF CONSTRUCTION:
 STAINLESS STEEL WETTED PARTS, ANODISED ALLOY AND PLATED STEEL EXTERNAL
 NITRILE SEALS, POLYURETHANE MAIN SEAL AS STANDARD
 OTHER OPTIONS AVAILABLE, CONSULT FACTORY.
- MANUAL HAND PUMP SECTION: 'MW' SINGLE-SPEED PUMP SHOWN
 SEE DATASHEET FOR MODELS
 'MW' UNITS, MULTIPLE MODELS FROM 50 BAR TO 700 BAR MAX PRESSURE.
 MATERIALS OF CONSTRUCTION:
 -3 UNITS STAINLESS STEEL 316, 303, 304, 302, 431, 420, CW307G ALUMINIUM BRONZE
 -A UNITS ANODISED ALLOY & PLATED STEEL EXTERNAL. STAINLESS STEEL WETTED.
 SEALS: NITRILE, FILLED PTFE, PTFE, UHMWP.
- OPERATING TEMPERATURE RANGE -20 TO +80 DEGREE C SUBJECT TO FLUID
- DIMENSIONS IN mm
- WORKING FLUIDS: MINERAL OIL, WATER OR OTHER. CONSULT FACTORY
- MASS 27KG APPROX
- AIR DRIVEN PUMP MAX PRESSURE SET ON AIR REGULATOR, LOCKABLE TWIST KNOB
- INLET CHECK VALVE: SOFT SEAT. REPLACEMENT SERVICE KITS AVAILABLE
- OUTLET CHECK VALVE: STAINLESS STEEL POPPET. REPLACEMENT SERVICE KITS AVAILABLE.
- 63mm PRESSURE GAUGE OPTIONAL. SHOWN FITTED.
- 20 LITRE 2-WHEEL TROLLEY SHOWN. 50 LITRE MODEL ALSO AVAILABLE.
- OUTLET HOSES AND ADAPTOR FITTINGS AVAILABLE. CONSULT FACTORY.

UNLESS OTHERWISE STATED:
 DIMENSIONS IN MILLIMETRES
 SURFACE FINISH IN MICROMETRES
 REMOVE SHARP EDGES

© COPYRIGHT 2022 SARUM HYDRAULICS LTD.



SARUM HYDRAULICS LTD.

SALISBURY, SP4 6EB, UK
 www.sarum-hydraulics.co.uk

TITLE
INST DRAWING: DUO, COMPACT, SINGLE-SPEED, 20L TROLLEY

DRAWN NO	APP
	CHKD
SCALE F SIZE	SHEET OF
CAD 2-D	DUO-C-MW-2T
DRAWING NO.	DUO-C-MW-2T

1	FIRST ISSUE	08/22	MATERIAL PER NOTES
ISSUE	D.C.N.	CHANGE DESCRIPTION & DATE	DATE IMPLEMENTED

IF IN DOUBT, ASK THIRD ANGLE PROJECTION

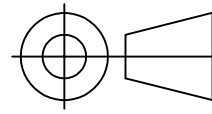

TOLERANCES UNLESS OTHERWISE STATED
 GENERAL TOLERANCES RIGHT ANGLE BENDS &
 NO DEC. PLACE +/-1.0mm OTHER ANGLES +/-1°
 ONE DEC. PLACE +/-0.3mm MACHINED DIAMETERS
 TWO DEC. PLACE +/-0.1mm CONCENTRIC WITHIN
 +/-0.1mm T.I.R.
 SCREW THREADS ARE ISO METRIC COARSE PITCH
 TOL. 6g/6H (MED. FIT) TO BS3643
 WIRE DIA./PLATE THICKNESS TO COMMERCIAL LIMITS
 GEOMETRICAL TOLERANCING TO BS308 PART 3

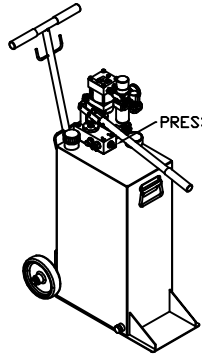

PRESSURE OUTLET G1/4 MALE CONED

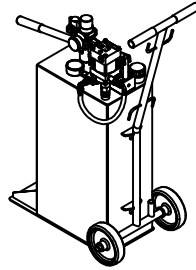
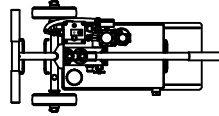

HYDRAULIC CIRCUIT
 STANDARD TEST/FILLER UNIT
 NOTE OPTIONS FITTED

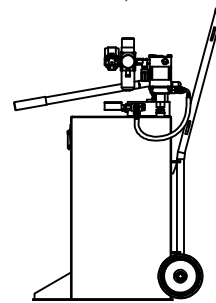
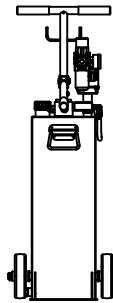
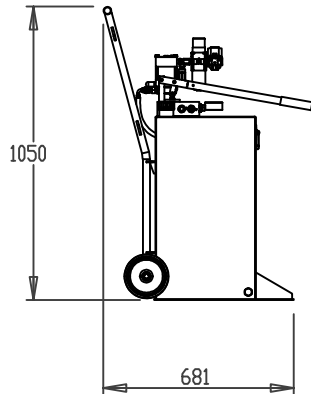
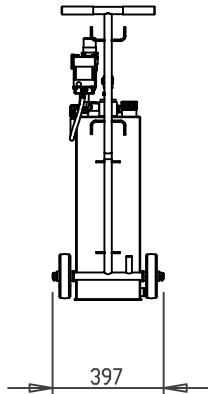
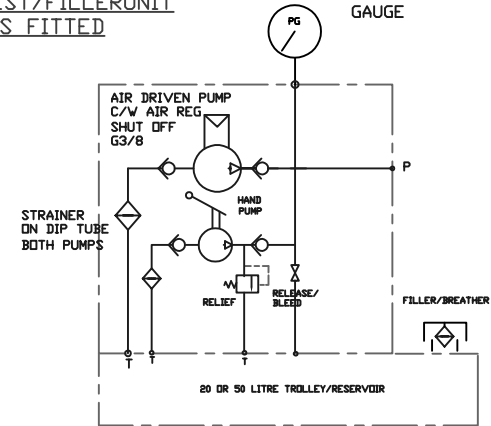

- NOTES:
- UNIT MANUFACTURED FROM STANDARD SARUM HYDRAULICS MICROPAC PUMP COMPONENTS
 - AIR DRIVEN PUMP SECTION: "COMPACT" MODEL SHOWN
 SEE DATASHEET FOR MODELS
 "COMPACT" UNITS UP TO 3.6 LITRES/MINUTE
 OR UP TO 740 BAR
 MATERIALS OF CONSTRUCTION:
 STAINLESS STEEL WETTED PARTS, ANODISED ALLOY AND PLATED STEEL EXTERNAL
 NITRILE SEALS, POLYURETHANE MAIN SEAL AS STANDARD
 OTHER OPTIONS AVAILABLE, CONSULT FACTORY.
 - MANUAL HAND PUMP SECTION: "MW" SINGLE-SPEED PUMP SHOWN
 SEE DATASHEET FOR MODELS
 "MW" UNITS, MULTIPLE MODELS FROM 50 BAR TO 700 BAR MAX PRESSURE.
 MATERIALS OF CONSTRUCTION:
 -3 UNITS STAINLESS STEEL 316, 303, 304, 302, 431, 420, CW307G ALUMINIUM BRONZE
 -A UNITS ANODISED ALLOY & PLATED STEEL EXTERNAL. STAINLESS STEEL WETTED.
 SEALS: NITRILE, FILLED PTFE, PTFE, UHMWP.
 - OPERATING TEMPERATURE RANGE -20 TO +80 DEGREE C SUBJECT TO FLUID
 - DIMENSIONS IN mm
 - WORKING FLUIDS: MINERAL OIL, WATER OR OTHER. CONSULT FACTORY
 - MASS 34KG APPROX
 - AIR DRIVEN PUMP MAX PRESSURE SET ON AIR REGULATOR, LOCKABLE TWIST KNOB
 - INLET CHECK VALVE: SOFT SEAT. REPLACEMENT SERVICE KITS AVAILABLE
 - OUTLET CHECK VALVE: STAINLESS STEEL POPPET. REPLACEMENT SERVICE KITS AVAILABLE.
 - 63mm PRESSURE GAUGE OPTIONAL. SHOWN FITTED.
 - 50 LITRE 2-WHEEL TROLLEY SHOWN. 20 LITRE MODEL ALSO AVAILABLE.
 - OUTLET HOSES AND ADAPTOR FITTINGS AVAILABLE. CONSULT FACTORY.

UNLESS OTHERWISE STATED:
 DIMENSIONS IN MILLIMETRES
 SURFACE FINISH IN MICROMETRES
 REMOVE SHARP EDGES

© COPYRIGHT 2022 SARUM HYDRAULICS LTD.



SARUM HYDRAULICS LTD.

SALISBURY, SP4 6EB, UK
 www.sarum-hydraulics.co.uk

TITLE
 INST DRAWING: DUO, COMPACT, SINGLE-SPEED, 50L TROLLEY

DRAWN NO	APP
	CHKD
SCALE F SIZE	SHEET OF
CAD 2-D	DUO-C-MW-5T
DRAWING NO.	DUO-C-MW-5T

1	FIRST ISSUE	08/22	MATERIAL PER NOTES
ISSUE	D.C.N.	CHANGE DESCRIPTION & DATE	DATE IMPLEMENTED

IF IN DOUBT, ASK THIRD ANGLE PROJECTION

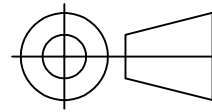

TOLERANCES UNLESS OTHERWISE STATED
 GENERAL TOLERANCES RIGHT ANGLE BENDS &
 NO DEC. PLACE +/-1.0mm OTHER ANGLES +/-1°
 ONE DEC. PLACE +/-0.3mm MACHINED DIAMETERS
 TWO DEC. PLACE +/-0.1mm CONCENTRIC WITHIN
 +/-0.1mm T.I.R.
 SCREW THREADS ARE ISO METRIC COARSE PITCH
 TOL. 6g/6H (MED. FIT) TO BS3643
 WIRE DIA./PLATE THICKNESS TO COMMERCIAL LIMITS
 GEOMETRICAL TOLERANCING TO BS308 PART 3

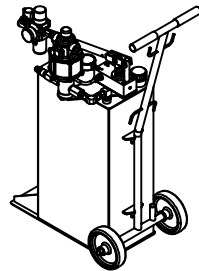
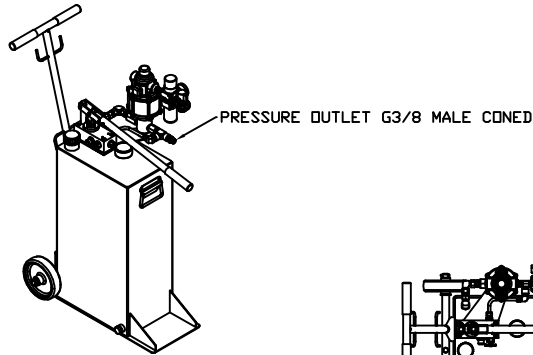

HYDRAULIC CIRCUIT
STANDARD TEST/FILLERUNIT
NOTE OPTIONS FITTED

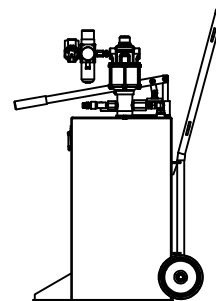
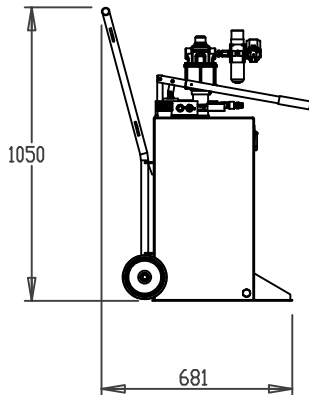
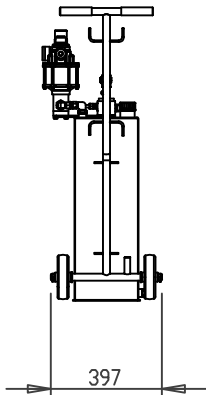
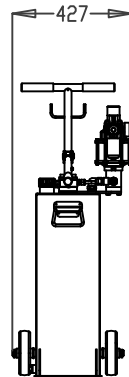
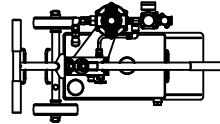
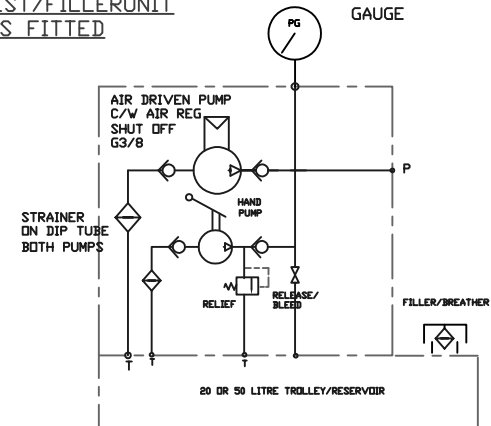

- NOTES:
- UNIT MANUFACTURED FROM STANDARD SARUM HYDRAULICS MICROPAC PUMP COMPONENTS
 - AIR DRIVEN PUMP SECTION: "HI-FLO" MODEL SHOWN
 SEE DATASHEET FOR MODELS
 "HI-FLO" UNITS UP TO 8.2 LITRES/MINUTE
 OR UP TO 125 BAR
 MATERIALS OF CONSTRUCTION:
 STAINLESS STEEL WETTED PARTS, ANODISED ALLOY AND PLATED STEEL EXTERNAL
 NITRILE SEALS, POLYURETHANE MAIN SEAL AS STANDARD
 OTHER OPTIONS AVAILABLE, CONSULT FACTORY.
 - MANUAL HAND PUMP SECTION: "MW" SINGLE-SPEED PUMP SHOWN
 SEE DATASHEET FOR MODELS
 "MW" UNITS, MULTIPLE MODELS FROM 50 BAR TO 700 BAR MAX PRESSURE.
 MATERIALS OF CONSTRUCTION:
 -3 UNITS STAINLESS STEEL 316, 303, 304, 302, 431, 420, CW307G ALUMINIUM BRONZE
 -A UNITS ANODISED ALLOY & PLATED STEEL EXTERNAL. STAINLESS STEEL WETTED.
 SEALS: NITRILE, FILLED PTFE, PTFE, UHMWP.
 - OPERATING TEMPERATURE RANGE -20 TO +80 DEGREE C SUBJECT TO FLUID
 - DIMENSIONS IN mm
 - WORKING FLUIDS: MINERAL OIL, WATER OR OTHER. CONSULT FACTORY
 - MASS 38KG APPROX
 - AIR DRIVEN PUMP MAX PRESSURE SET ON AIR REGULATOR, LOCKABLE TWIST KNOB
 - INLET CHECK VALVE: SOFT SEAT. REPLACEMENT SERVICE KITS AVAILABLE
 - OUTLET CHECK VALVE: STAINLESS STEEL POPPET. REPLACEMENT SERVICE KITS AVAILABLE.
 - 63mm PRESSURE GAUGE OPTIONAL. SHOWN FITTED.
 - 50 LITRE 2-WHEEL TROLLEY.
 - OUTLET HOSES AND ADAPTOR FITTINGS AVAILABLE. CONSULT FACTORY.

UNLESS OTHERWISE STATED:
 DIMENSIONS IN MILLIMETRES
 SURFACE FINISH IN MICROMETRES
 REMOVE SHARP EDGES

© COPYRIGHT 2022 SARUM HYDRAULICS LTD.



SARUM HYDRAULICS LTD.

SALISBURY, SP4 6EB, UK
 www.sarum-hydraulics.co.uk

TITLE
 INST DRAWING: DUO, HI-FLO, SINGLE-SPEED, 50L TROLLEY

DRAWN NO	APP
	CHKD
SCALE F SIZE	SHEET OF
CAD 2-D	DUO-H-MW-5T
DRAWING NO.	DUO-H-MW-5T

1	FIRST ISSUE	08/22	MATERIAL PER NOTES
ISSUE	D.C.N.	CHANGE DESCRIPTION & DATE	DATE IMPLEMENTED

IF IN DOUBT, ASK THIRD ANGLE PROJECTION

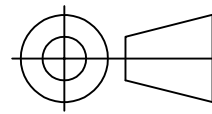

TOLERANCES UNLESS OTHERWISE STATED
 GENERAL TOLERANCES RIGHT ANGLE BENDS &
 NO DEC. PLACE +/-1.0mm OTHER ANGLES +/-1°
 ONE DEC. PLACE +/-0.3mm MACHINED DIAMETERS
 TWO DEC. PLACE +/-0.1mm CONCENTRIC WITHIN
 +/-0.1mm T.I.R.
 SCREW THREADS ARE ISO METRIC COARSE PITCH
 TOL. 6g/6H (MED. FIT) TO BS3643
 WIRE DIA./PLATE THICKNESS TO COMMERCIAL LIMITS
 GEOMETRICAL TOLERANCING TO BS308 PART 3

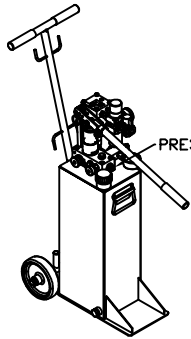

PRESSURE OUTLET G1/4 MALE CONED

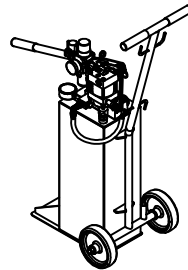
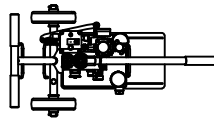

HYDRAULIC CIRCUIT
STANDARD TEST/FILLERUNIT
NOTE OPTIONS FITTED

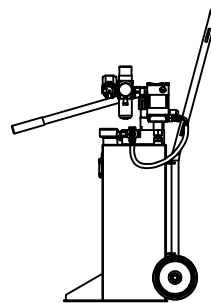
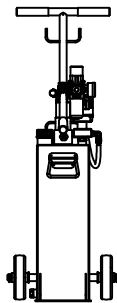
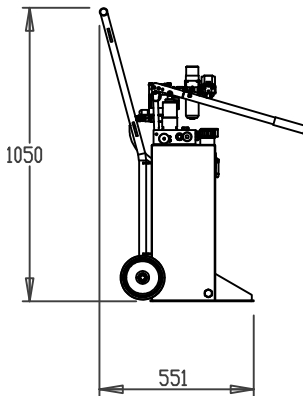
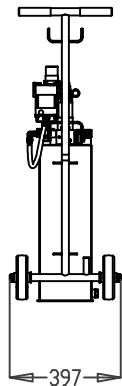
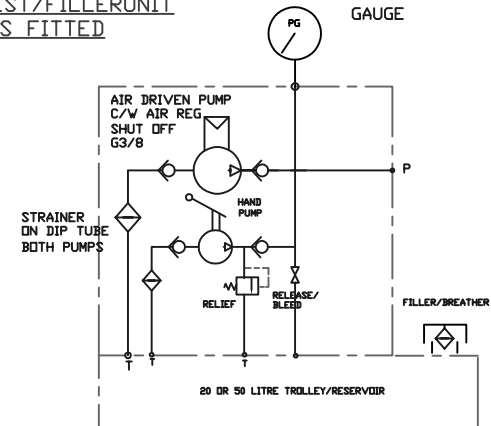

- NOTES:
- UNIT MANUFACTURED FROM STANDARD SARUM HYDRAULICS MICROPAC PUMP COMPONENTS
 - AIR DRIVEN PUMP SECTION: 'COMPACT' MODEL SHOWN
 SEE DATASHEET FOR MODELS
 'COMPACT' UNITS UP TO 3.6 LITRES/MINUTE
 OR UP TO 740 BAR
 MATERIALS OF CONSTRUCTION:
 STAINLESS STEEL WETTED PARTS, ANODISED ALLOY AND PLATED STEEL EXTERNAL
 NITRILE SEALS, POLYURETHANE MAIN SEAL AS STANDARD
 OTHER OPTIONS AVAILABLE, CONSULT FACTORY.
 - MANUAL HAND PUMP SECTION: 'MD' TWO-SPEED PUMP SHOWN
 SEE DATASHEET FOR MODELS
 'MD' UNITS 450 BAR OR 700 BAR MAX PRESSURE.
 MATERIALS OF CONSTRUCTION:
 STAINLESS STEEL 316, 303, 304, 302, 431, 420,
 CW307G ALUMINIUM BRONZE
 SEALS: NITRILE, FILLED PTFE, PTFE, UHMWP.
 - OPERATING TEMPERATURE RANGE -20 TO +80 DEGREE C SUBJECT TO FLUID
 - DIMENSIONS IN mm
 - WORKING FLUIDS: MINERAL OIL, WATER OR OTHER. CONSULT FACTORY
 - MASS 28KG APPROX
 - AIR DRIVEN PUMP MAX PRESSURE SET ON AIR REGULATOR, LOCKABLE TWIST KNOB
 - INLET CHECK VALVE: SOFT SEAT. REPLACEMENT SERVICE KITS AVAILABLE
 - OUTLET CHECK VALVE: STAINLESS STEEL POPPET. REPLACEMENT SERVICE KITS AVAILABLE.
 - 63mm PRESSURE GAUGE OPTIONAL. SHOWN FITTED.
 - 20 LITRE 2-WHEEL TROLLEY SHOWN. 50 LITRE MODEL ALSO AVAILABLE.
 - OUTLET HOSES AND ADAPTOR FITTINGS AVAILABLE. CONSULT FACTORY.

UNLESS OTHERWISE STATED:
 DIMENSIONS IN MILLIMETRES
 SURFACE FINISH IN MICROMETRES
 REMOVE SHARP EDGES

© COPYRIGHT 2022 SARUM HYDRAULICS LTD.



SARUM HYDRAULICS LTD.

SALISBURY, SP4 6EB, UK
 www.sarum-hydraulics.co.uk

TITLE
 INST DRAWING: DUO, COMPACT, TWO-SPEED, 20L TROLLEY

DRAWN NO	APP
	CHKD
SCALE F SIZE	SHEET OF
CAD 2-D	DUO-C-MD-2T
DRAWING NO.	DUO-C-MD-2T

1	FIRST ISSUE	08/22	MATERIAL PER NOTES
ISSUE	D.C.N.	CHANGE DESCRIPTION & DATE	DATE IMPLEMENTED

IF IN DOUBT, ASK THIRD ANGLE PROJECTION

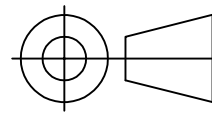

TOLERANCES UNLESS OTHERWISE STATED
 GENERAL TOLERANCES RIGHT ANGLE BENDS &
 NO DEC. PLACE +/-1.0mm OTHER ANGLES +/-1°
 ONE DEC. PLACE +/-0.3mm MACHINED DIAMETERS
 TWO DEC. PLACE +/-0.1mm CONCENTRIC WITHIN
 +/-0.1mm T.I.R.
 SCREW THREADS ARE ISO METRIC COARSE PITCH
 TOL. 6g/6H (MED. FIT) TO BS3643
 WIRE DIA./PLATE THICKNESS TO COMMERCIAL LIMITS
 GEOMETRICAL TOLERANCING TO BS308 PART 3

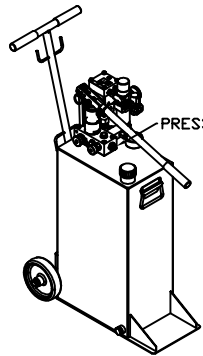

PRESSURE OUTLET G1/4 MALE CONED

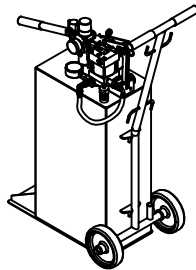
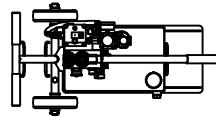

HYDRAULIC CIRCUIT
 STANDARD TEST/FILLERUNIT
 NOTE OPTIONS FITTED

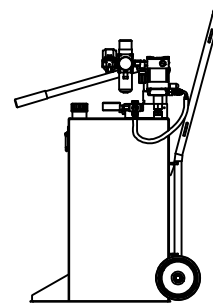
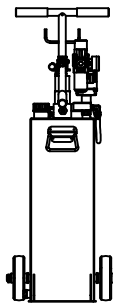
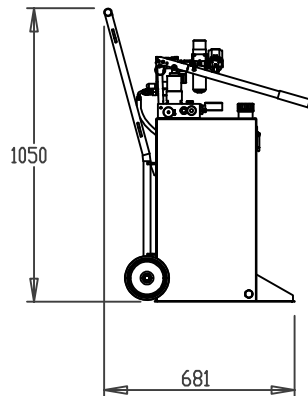
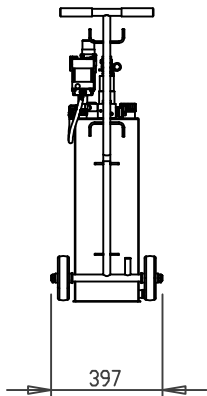
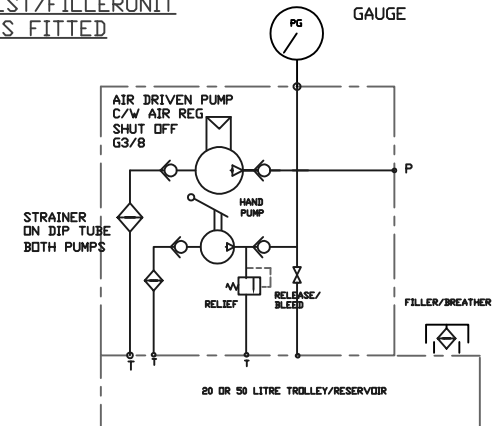

NOTES:

- UNIT MANUFACTURED FROM STANDARD SARUM HYDRAULICS MICROPAC PUMP COMPONENTS
- AIR DRIVEN PUMP SECTION: "COMPACT" MODEL SHOWN
 SEE DATASHEET FOR MODELS "COMPACT" UNITS UP TO 3.6 LITRES/MINUTE OR UP TO 740 BAR
 MATERIALS OF CONSTRUCTION: STAINLESS STEEL WETTED PARTS, ANODISED ALLOY AND PLATED STEEL EXTERNAL NITRILE SEALS, POLYURETHANE MAIN SEAL AS STANDARD OTHER OPTIONS AVAILABLE, CONSULT FACTORY.
- MANUAL HAND PUMP SECTION: "MD" TWO-SPEED PUMP SHOWN
 SEE DATASHEET FOR MODELS "MD" UNITS 450 BAR OR 700 BAR MAX PRESSURE.
 MATERIALS OF CONSTRUCTION: STAINLESS STEEL 316, 303, 304, 302, 431, 420, CW307G ALUMINIUM BRONZE
 SEALS: NITRILE, FILLED PTFE, PTFE, UHMWP.
- OPERATING TEMPERATURE RANGE -20 TO +80 DEGREE C SUBJECT TO FLUID
- DIMENSIONS IN mm
- WORKING FLUIDS: MINERAL OIL, WATER OR OTHER. CONSULT FACTORY
- MASS 35KG APPROX
- AIR DRIVEN PUMP MAX PRESSURE SET ON AIR REGULATOR, LOCKABLE TWIST KNOB
- INLET CHECK VALVE: SOFT SEAT. REPLACEMENT SERVICE KITS AVAILABLE
- OUTLET CHECK VALVE: STAINLESS STEEL POPPET. REPLACEMENT SERVICE KITS AVAILABLE.
- 63mm PRESSURE GAUGE OPTIONAL. SHOWN FITTED.
- 50 LITRE 2-WHEEL TROLLEY SHOWN. 20 LITRE MODEL ALSO AVAILABLE.
- OUTLET HOSES AND ADAPTOR FITTINGS AVAILABLE. CONSULT FACTORY.

UNLESS OTHERWISE STATED:
 DIMENSIONS IN MILLIMETRES
 SURFACE FINISH IN MICROMETRES
 REMOVE SHARP EDGES

© COPYRIGHT 2022 SARUM HYDRAULICS LTD.



SARUM HYDRAULICS LTD.

SALISBURY, SP4 6EB, UK
 www.sarum-hydraulics.co.uk

TITLE
 INST DRAWING: DUO, COMPACT, TWO-SPEED, 50L TROLLEY

DRAWN NO	APP
	CHKD
SCALE F SIZE	SHEET OF
CAD 2-D	DUO-C-MD-5T
DRAWING NO.	DUO-C-MD-5T

1	FIRST ISSUE	08/22	MATERIAL PER NOTES
ISSUE	D.C.N.	CHANGE DESCRIPTION & DATE	DATE IMPLEMENTED

IF IN DOUBT, ASK THIRD ANGLE PROJECTION

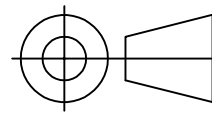

TOLERANCES UNLESS OTHERWISE STATED
 GENERAL TOLERANCES RIGHT ANGLE BENDS &
 NO DEC. PLACE +/-1.0mm OTHER ANGLES +/-1°
 ONE DEC. PLACE +/-0.3mm MACHINED DIAMETERS
 TWO DEC. PLACE +/-0.1mm CONCENTRIC WITHIN
 +/-0.1mm T.I.R.
 SCREW THREADS ARE ISO METRIC COARSE PITCH
 TOL. 6g/6H (MED. FIT) TO BS3643
 WIRE DIA./PLATE THICKNESS TO COMMERCIAL LIMITS
 GEOMETRICAL TOLERANCING TO BS308 PART 3

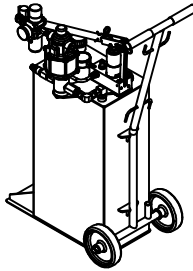
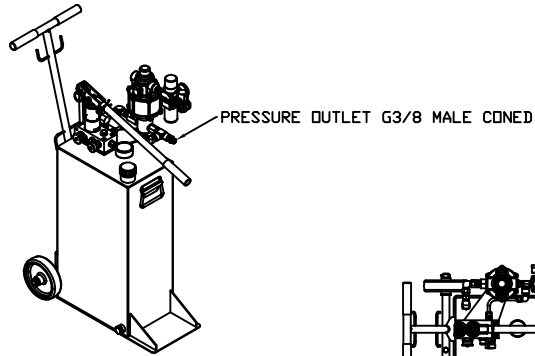

HYDRAULIC CIRCUIT
STANDARD TEST/FILLERUNIT
NOTE OPTIONS FITTED

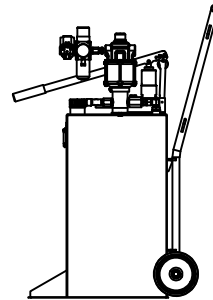
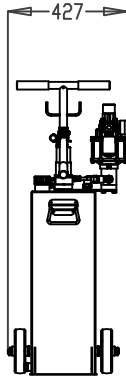
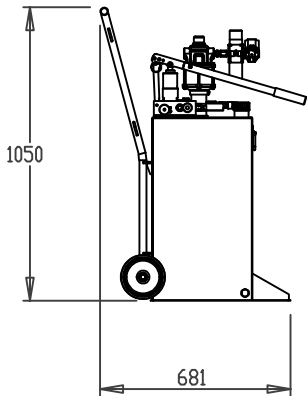
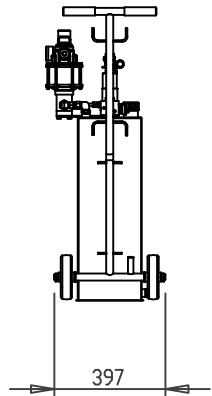
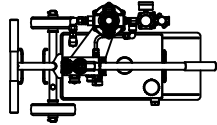
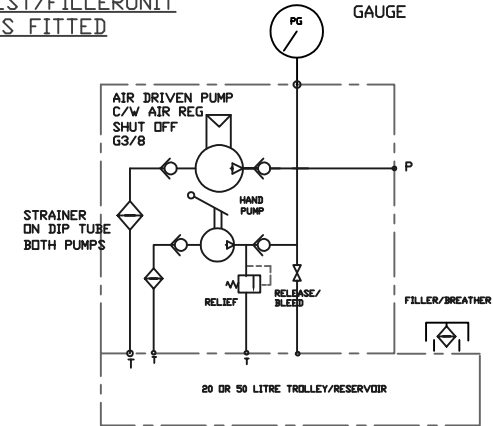

- NOTES:
- UNIT MANUFACTURED FROM STANDARD SARUM HYDRAULICS MICROPAC PUMP COMPONENTS
 - AIR DRIVEN PUMP SECTION: "HI-FLO" MODEL SHOWN
 SEE DATASHEET FOR MODELS
 "HI-FLO" UNITS UP TO 8.2 LITRES/MINUTE
 OR UP TO 125 BAR
 MATERIALS OF CONSTRUCTION:
 STAINLESS STEEL WETTED PARTS, ANODISED ALLOY AND PLATED STEEL EXTERNAL
 NITRILE SEALS, POLYURETHANE MAIN SEAL AS STANDARD
 OTHER OPTIONS AVAILABLE, CONSULT FACTORY.
 - MANUAL HAND PUMP SECTION: "MD" TWO-SPEED PUMP SHOWN
 SEE DATASHEET FOR MODELS
 "MD" UNITS 450 BAR OR 700 BAR MAX PRESSURE.
 MATERIALS OF CONSTRUCTION:
 STAINLESS STEEL 316, 303, 304, 302, 431, 420,
 CW307G ALUMINIUM BRONZE
 SEALS: NITRILE, FILLED PTFE, PTFE, UHMWP.
 - OPERATING TEMPERATURE RANGE -20 TO +80 DEGREE C SUBJECT TO FLUID
 - DIMENSIONS IN mm
 - WORKING FLUIDS: MINERAL OIL, WATER OR OTHER. CONSULT FACTORY
 - MASS 37KG APPROX
 - AIR DRIVEN PUMP MAX PRESSURE SET ON AIR REGULATOR, LOCKABLE TWIST KNOB
 - INLET CHECK VALVE: SOFT SEAT. REPLACEMENT SERVICE KITS AVAILABLE
 - OUTLET CHECK VALVE: STAINLESS STEEL POPPET. REPLACEMENT SERVICE KITS AVAILABLE.
 - 63mm PRESSURE GAUGE OPTIONAL. SHOWN FITTED.
 - 50 LITRE 2-WHEEL TROLLEY.
 - OUTLET HOSES AND ADAPTOR FITTINGS AVAILABLE. CONSULT FACTORY.

UNLESS OTHERWISE STATED:
 DIMENSIONS IN MILLIMETRES
 SURFACE FINISH IN MICROMETRES
 REMOVE SHARP EDGES

© COPYRIGHT 2022 SARUM HYDRAULICS LTD.



SARUM HYDRAULICS LTD.

SALISBURY, SP4 6EB, UK
 www.sarum-hydraulics.co.uk

TITLE
 INST DRAWING: DUO, HI-FLO, TWO-SPEED, 50L TROLLEY

DRAWN NO	APP
	CHKD
SCALE F SIZE	SHEET OF
CAD 2-D	DUO-H-MD-5T
DRAWING NO.	
DUO-H-MD-5T	

1	FIRST ISSUE	08/22	MATERIAL PER NOTES
ISSUE	D.C.N.	CHANGE DESCRIPTION & DATE	DATE IMPLEMENTED
			FINISH PER NOTES