

IF IN DOUBT, ASK THIRD ANGLE PROJECTION

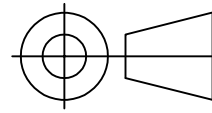

TOLERANCES UNLESS OTHERWISE STATED
 GENERAL TOLERANCES RIGHT ANGLE BENDS &
 NO DEC. PLACE +/-1.0mm OTHER ANGLES +/-1°
 ONE DEC. PLACE +/-0.3mm MACHINED DIAMETERS
 TWO DEC. PLACE +/-0.1mm CONCENTRIC WITHIN
 +/-0.1mm T.I.R.
 SCREW THREADS ARE ISO METRIC COARSE PITCH
 TOL. 6g/6H (MED. FIT) TO BS3643
 WIRE DIA./PLATE THICKNESS TO COMMERCIAL LIMITS
 GEOMETRICAL TOLERANCING TO BS308 PART 3

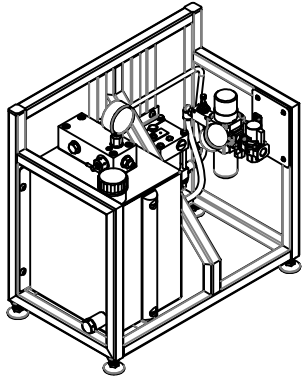

3/16 CONNECTION MANIFOLD 2 X G1/4 CONNECTIONS
 1 X TANK CONNECTION
 OPTIONAL CERTIFIED RELIEF VALVE CAN BE FITTED

HOLD/RELEASE VALVE

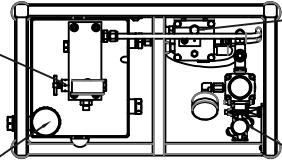

AIR DRIVEN PUMP
 SEE NOTE FOR MODELS

OVERSIZE POLYMER FILLER/BREATHER
 FOR EASY FILLING

AIR CONTROLS
 SHUT OFF VALVE/FILTER/REGULATOR
 AIR INLET PRESSURE GAUGE

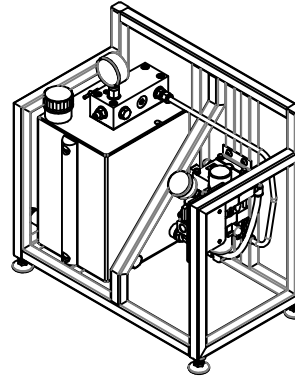

NOTES

- MATERIALS OF CONSTRUCTION
 STAINLESS STEEL WETTED PARTS
 STAINLESS STEEL FRAME
- ALL DIMENSIONS IN mm
- MASS 30 KG DRY
- USE DATA SHEET 336009200 FOR ORDERING CODES
- THE RESERVOIR IS NOT A PRESSURE VESSEL.
 IT MUST ALWAYS BE VENTED TO ATMOSPHERE
 MAXIMUM INTERNAL PRESSURE 0.3 BARG
- ALTERNATIVE MODELS AVAILABLE:
 PUMP ALONE
 PUMP WITH RESERVOIR (THIS MODEL)
 PUMP WITH RESERVOIR & PLC CONTROLLER
- MODEL SHOWN IS STANDARD COMPACT PUMP TO 700 BAR;
 FLOW RATE UP TO 5 LITRES/MINUTE, AIR SUPPLY 10CFM
 OPTIONAL HIGH FLOW UNIT UP TO 700 BAR;
 FLOW RATE UP TO 7 LITRES/MINUTE, AIR SUPPLY 14CFM
- LARGER RESERVOIRS AVAILABLE

POLYMER LEVEL INDICATOR
 FLOAT SWITCH STOPS RUNNING DRY

HYDRAULIC OUTLET PRESSURE GAUGE

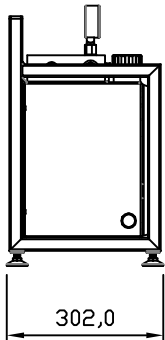

501,7

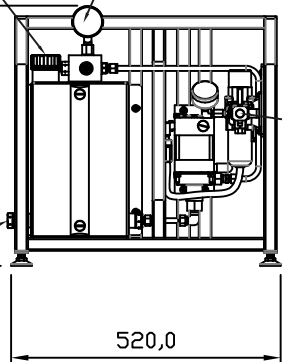

G3/8 SHOP AIR INLET
 6PSI/41 BAR TO 12PSI/0.6 BAR
 OPTIONAL QUICK DISCONNECT/ HOSE ASSY

RESERVOIR DRAIN PLUG G1/2

520,0

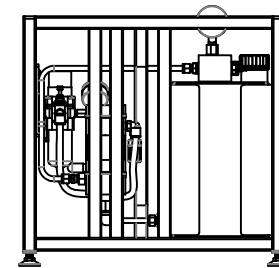
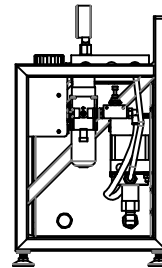

UNLESS OTHERWISE STATED:
 DIMENSIONS IN MILLIMETRES
 SURFACE FINISH IN MICROMETRES
 REMOVE SHARP EDGES

© COPYRIGHT 2021 SARUM HYDRAULICS LTD.



SARUM HYDRAULICS LTD.

SALISBURY, SP4 6EB, UK
 www.sarum-hydraulics.co.uk

DRAWN NO APP

CHKD

SCALE F SIZE SHEET OF

CAD 2-D 336100100

TITLE
 INSTALLATION DRAWING PRESSURE TEST RIG/ RESERVOIR

DRAWING NO.

336100100

1	FIRST ISSUE	05/21
ISSUE	D.C.N.	CHANGE DESCRIPTION & DATE
		DATE IMPLEMENTED

MATERIAL PER NOTE
 FINISH PER NOTE

IF IN DOUBT, ASK THIRD ANGLE PROJECTION

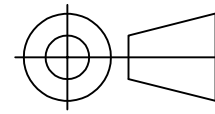

TOLERANCES UNLESS OTHERWISE STATED
 GENERAL TOLERANCES RIGHT ANGLE BENDS &
 NO DEC. PLACE +/-1.0mm OTHER ANGLES +/-1°
 ONE DEC. PLACE +/-0.3mm MACHINED DIAMETERS
 TWO DEC. PLACE +/-0.1mm CONCENTRIC WITHIN
 +/-0.1mm T.I.R.
 SCREW THREADS ARE ISO METRIC COARSE PITCH
 TOL. 6g/6h (MED. FIT) TO BS3643
 WIRE DIA./PLATE THICKNESS TO COMMERCIAL LIMITS
 GEOMETRICAL TOLERANCING TO BS308 PART 3

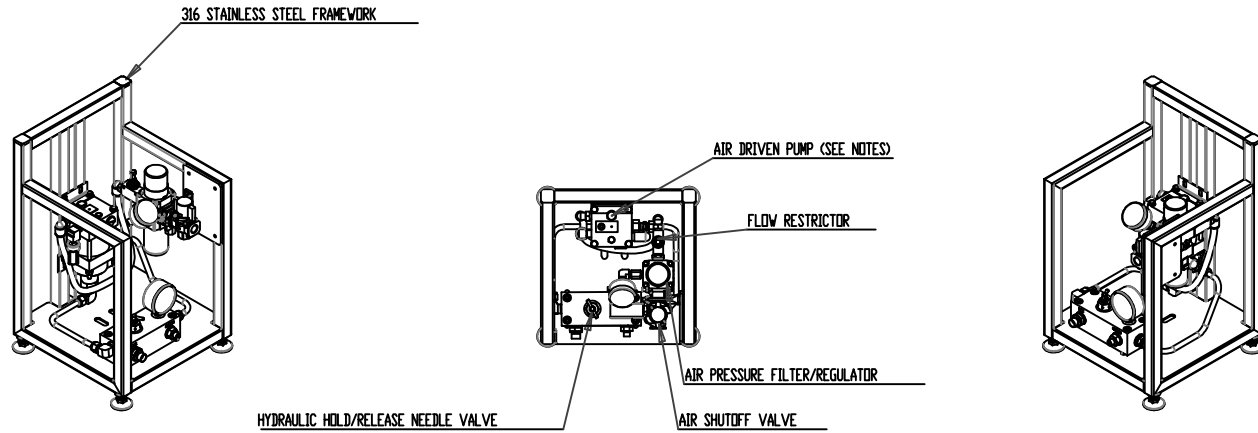

NOTES

1. MATERIALS OF CONSTRUCTION
 STAINLESS STEEL WETTED PARTS
 STAINLESS STEEL FRAME
2. ALL DIMENSIONS IN mm
3. MASS 20 KG DRY
4. USE DATA SHEET 336009200 FOR ORDERING CODES
5. ALTERNATIVE MODELS AVAILABLE:
 PUMP ALONE (THIS MODEL)
 PUMP WITH RESERVOIR
 PUMP WITH RESERVOIR & PLC CONTROLLER
6. MODEL SHOWN IS STANDARD COMPACT PUMP TO 700 BAR:
 FLOW RATE UP TO 5 LITRES/MINUTE, AIR SUPPLY 10CFM
 OPTIONAL HIGH FLOW UNIT UP TO 700 BAR:
 FLOW RATE UP TO 7 LITRES/MINUTE, AIR SUPPLY 14CFM

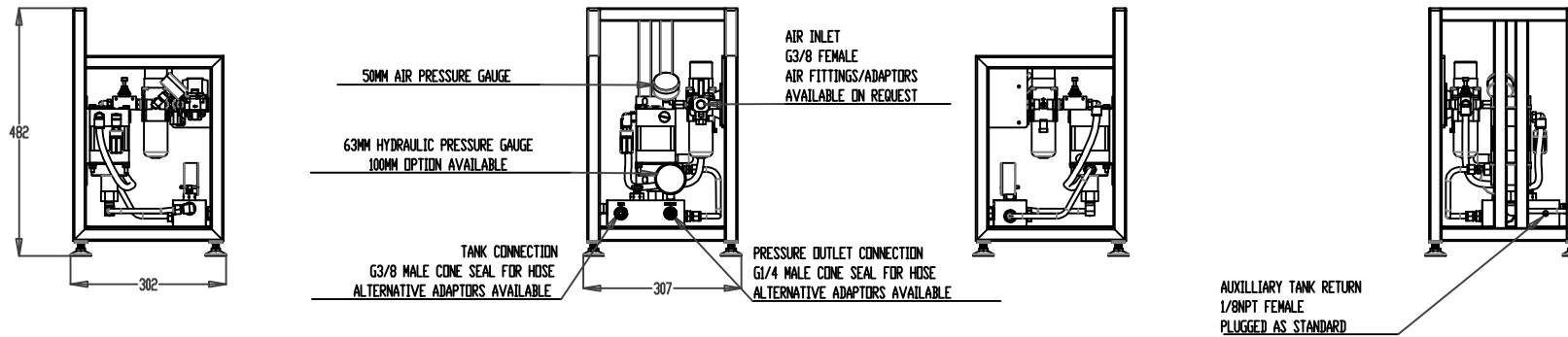

UNLESS OTHERWISE STATED:
 DIMENSIONS IN MILLIMETRES
 SURFACE FINISH IN MICROMETRES
 REMOVE SHARP EDGES

© COPYRIGHT 2021 SARUM HYDRAULICS LTD.



SARUM HYDRAULICS LTD.

SALISBURY, SP4 6EB, UK
 www.sarum-hydraulics.co.uk

TITLE
INSTALLATION DRAWING PRESSURE TEST RIG

DRAWN NO	APP
	CHKD
SCALE F SIZE	SHEET OF
CAD 2-D	336200100

DRAWING NO.
336200100

1	FIRST ISSUE	05/21
ISSUE	D.C.N.	CHANGE DESCRIPTION & DATE
		DATE IMPLEMENTED

MATERIAL PER NOTE
 FINISH PER NOTE