

IF IN DOUBT, ASK

THIRD ANGLE PROJECTION

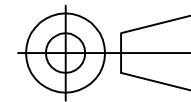

TOLERANCES UNLESS OTHERWISE STATED
 GENERAL TOLERANCES NO DEC. PLACE +/-1.0mm
 ONE DEC. PLACE +/-0.3mm
 TWO DEC. PLACE +/-0.1mm
 OTHERWISE STATED RIGHT ANGLE BENDS & OTHER ANGLES +/-1°
 MACHINED DIAMETERS CONCENTRIC WITHIN +/-0.1mm T.I.R.
 SCREW THREADS ARE ISO METRIC COARSE PITCH TOL. 6g/6H (MED. FIT) TO BS3643
 WIRE DIA./PLATE THICKNESS TO COMMERCIAL LIMITS
 GEOMETRICAL TOLERANCING TO BS308 PART 3

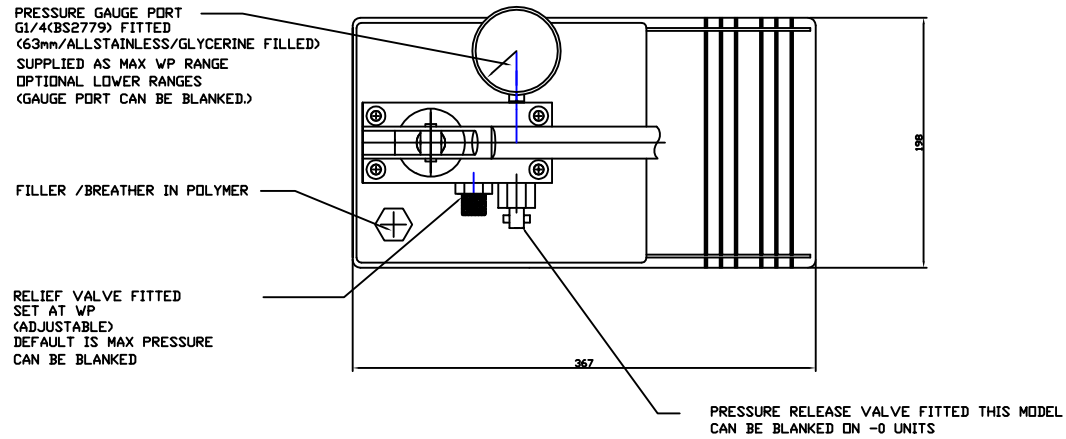

PUMP UNIT MP-MIST TEST UNIT
 5 LITRE PORTABLE ALLOY/ STAINLESS TEST SET
 STANDARD UNITS FOR MIST SYSTEMS
 STAINLESS 316 UNITS AND OTHER OPTIONS- ENQUIRE DIRECT

NOTES

- PRESSURE/DISPLACEMENTS
 12CC/DOUBLE STROKE TO 407 BAR MIST UNIT
 - GENERAL MW-A-12 MATERIALS OPTIONS FOR WATER, CONSULT FACTORY IF IN DOUBT
 - MATERIALS OF CONSTRUCTION
 STAINLESS STEEL BS970 316,303,304,302,431,420
 ALUMINIUM BRONZE CW307G
 ALUMINIUM ALLOY 6082T6 BS1474 ANODISED 10 MICRONS
 CARBON STEEL BS970 PLATED HANDLE MECHANISM
 NYLON, ACETAL, PVC
 SEALS: NITRILE, FILLED PTFE, PTFE, UHMWP
 - MASS 6KG 5 L DRY
 - DIMENSIONS IN mm
 - SPECIFICATION SUBJECT TO REVISION
 - FOR ALTERNATIVE FLUIDS/SEAL COMPOUNDS -CONSULT FACTORY
 - OPERATING TEMPERATURE RANGE -20 TO +80 DEG C SUBJECT TO FLUID
 - STANDARD UNIT SUPPLIED READY FOR USE AFTER CONNECTING HOSE
 - ENSURE USED IN ACCORDANCE WITH MANUAL HANDLING GUIDELINES AND REGULATIONS
 ACCORDANCE WITH STATUTORY & OTHER REQUIREMENTS
 - USE DATA SHEET 007045400 FOR ORDERING CODES
- ORDERING CODE FOR MICROPAC MP SERIES 316 PRESSURE TEST SETS
 MW-A-12 BASIC 12CC/407 BAR ALLOY/STAINLESS PUMP WEBSHOP UNIT

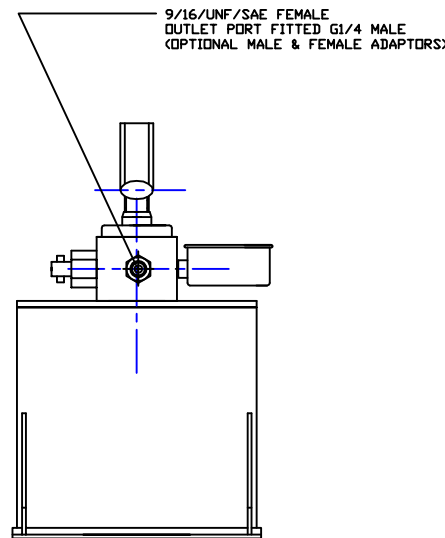
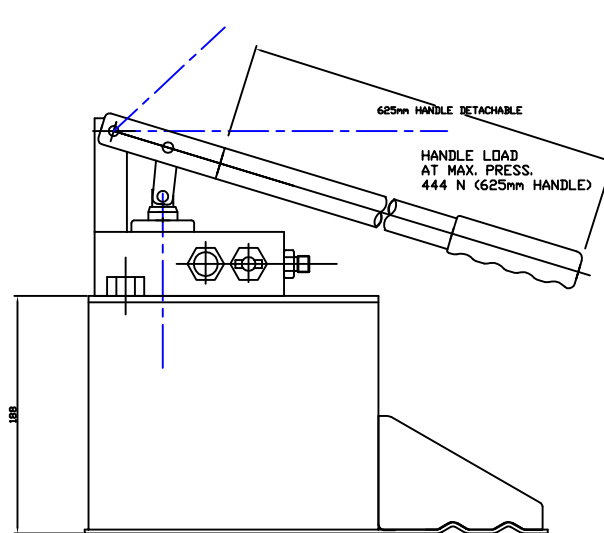

- ADD HANDLE, -6 IS 625MM, 625MM IS WEB UNIT
 ADD SEALS, -N IS MIST STANDARD NITRILE/UHMWP/PTFE,
 ADD TEST FLUID, -W IS WATER ON MIST UNIT,
 ADD RELEASE/HOLD VALVE, -R IS RELEASE/ HOLD VALVE FITTED ON MIST UNIT,
 ADD GAUGE OPTION, -G IS 63MM MAX RANGE PUMP BAR FITTED MIST UNIT, SEE TWO OPTIONS PER DATASHEET
 CONTACT WEB SHOP IF DIFFERENT GAUGE RANGE
 ADD RELIEF VALVE STANDARD ON MIST, TWO PRESSURES OFFERED.
 SPECIFY ALTERNATE RANGE ON ORDER BY CONTACTING FACTORY.
 ADD RESERVOIR -05 = 5 LITRE ALLOY PORTABLE STANDRD ON MIST, 10 AND 20 LITRE UNITS CONTACT FACTORY
 CONSULT FACTORY IF IN DOUBT.
 OPTIONAL 3 METRE HOSE ON MIST UNIT

UNLESS OTHERWISE STATED:
 DIMENSIONS IN MILLIMETRES
 SURFACE FINISH IN MICROMETRES
 REMOVE SHARP EDGES

© COPYRIGHT 1997 SARUM HYDRAULICS LTD.

					SARUM HYDRAULICS LTD. P.O. BOX 48, SALISBURY SP1 3YB TEL. 01722 328388 FAX. 01722 414307		DRAWN JGF APP
					TITLE MICROPAC PORTABLE ALLOY TEST SETS MP-MIST SERIES		CHKD SCALE FULL SIZE OF SHEET CAD 2-D MP-MIST TEST UNIT DRAWING NO.
1		FIRST ISSUE		10/17	MATERIAL PER NOTE	MP-MIST TEST PUMP	
ISS.	D.C.N.	CHANGE DESCRIPTION & DATE		DATE IMPLEMENTED	FINISH PER NOTE		